

 **419-442-7000**

 **cs@toledohydraulic.com**

 **www.toledohydraulic.com**

**TOLEDOHYDRAULIC**

## PRODUCT CATALOG

**Toledo Hydraulic**

Toledo, Ohio 43614  
United States

419-442-7000 

cs@toledohydraulic.com 

**FS CURTIS TOLEDO® VH33K1 HOSE SAW BLADE / KNIFE BRACKET MOUNTING FLAT WASHER 3/8" FITS FS CURTIS TOLEDO® HYDRAULIC HOSE SAW MODEL 9**

**SKU: FSC-FVH33K1**

**PRICE: \$17.00**

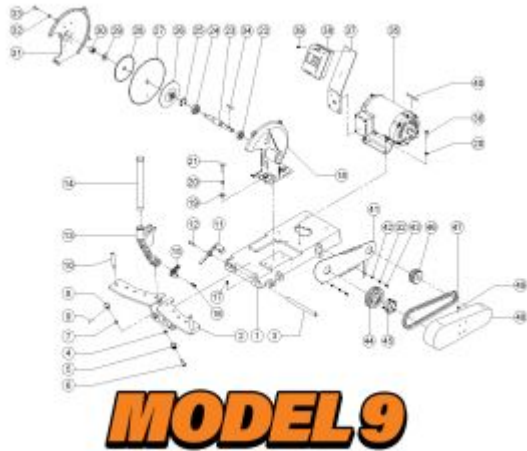

**PRODUCT DESCRIPTION**

This is a FVH33K1 Hose Saw Blade / Knife Bracket Mounting Flat Washer 3/8" that fits FS CURTIS TOLEDO Cut Off Machine Model 9. Replacement Parts are manufactured by FS CURTIS TOLEDO®

- Fits FS CURTIS TOLEDO® Model 9 Cut Off Machine
- FS CURTIS TOLEDO® Part: FVH33K1
- Number 19 in Model 9 Diagram. Max Quantity in Machine: 3

**ADDITIONAL INFORMATION**

More Information

Manufacturer

FS CURTIS TOLEDO

 **419-442-7000**

 **cs@toledohydraulic.com**

 **www.toledohydraulic.com**

**TOLEDO HYDRAULIC**